

SCUBAPRO

Technical Service Schematic

MK200 FIRST STAGE 10-200-000

Date 12/97

Revision C

Annual Repair Parts Kit #10-200-041

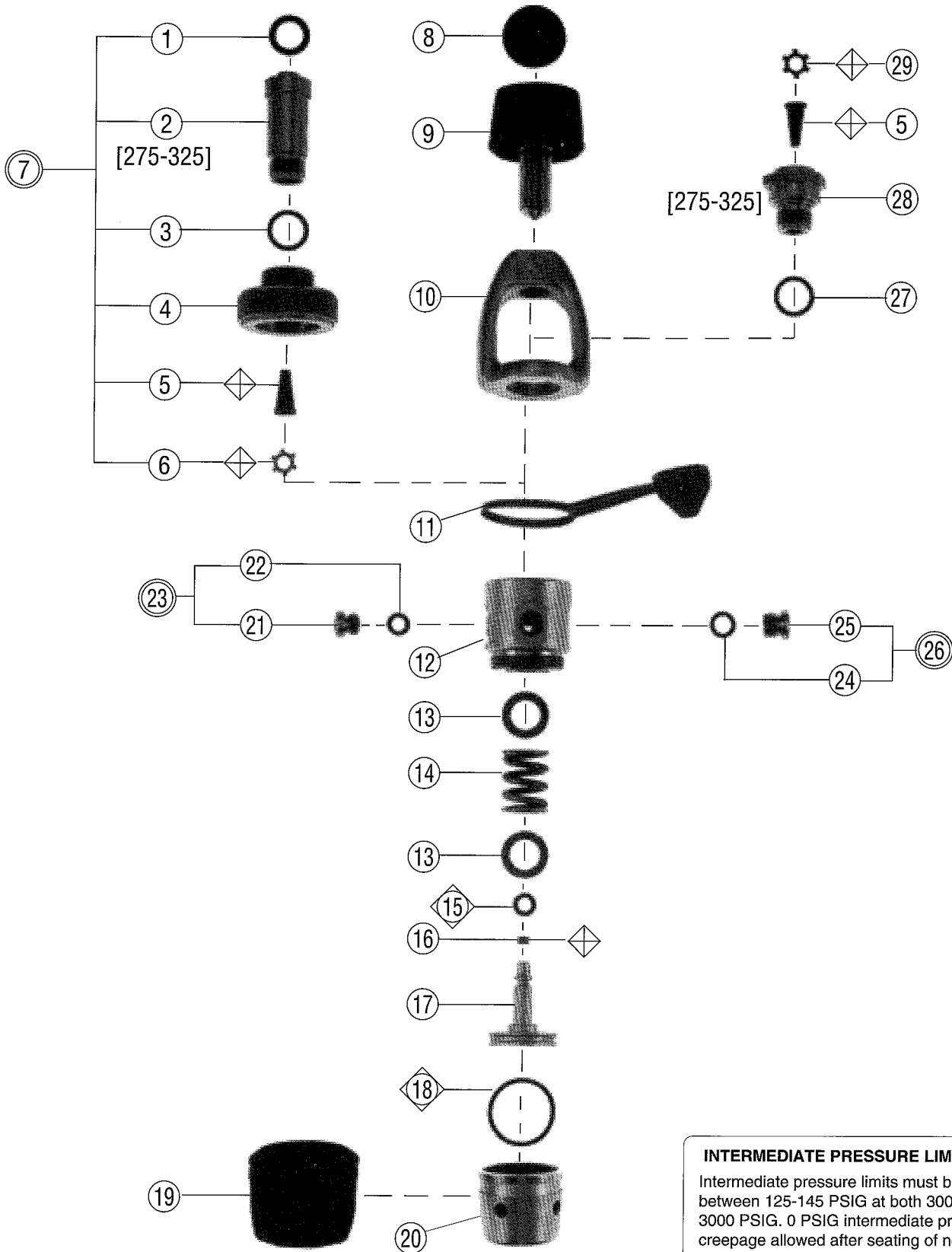

INTERMEDIATE PRESSURE LIMITS

Intermediate pressure limits must be between 125-145 PSIG at both 300 and 3000 PSIG. 0 PSIG intermediate pressure creepage allowed after seating of new seat

SCUBAPRO

Technical Service Schematic

MK200 FIRST STAGE 10-200-000

Date 12/97

Revision D

Annual Repair Parts Kit #10-200-041

Parts

#	QTY	PART #	DESCRIPTION	COST
	1	01-050-193	O-RING, DIN ADAPTER, BLACK	
	1	10-103-114	RETAINER, DIN, 300 BAR	
	1	01-050-380	O-RING, DIN ADAPTER, AMBER	
	1	10-105-118	KNOB, DIN, 300 BAR	
	1	01-028-109	FILTER, CONICAL	
	1	01-073-108	RETAINER, STAR	
○	1	10-043-030	KIT, DIN, 300 BAR, MK2, MK3, MK200	
	1	01-006-509	DECAL, MK200	
	1	10-200-008	YOKE SCREW, (9/16)	
	1	10-101-131	YOKE, (9/16), POLISHED	
	1	10-101-211	INLET PROTECTOR	
	1	10-103-110	BODY, MK200	
*	2	01-060-101	WASHER	
	1	01-020-101	SPRING	
	1	01-050-127	O-RING, PISTON SHAFT, AMBER	
	1	10-200-107	SEAT, PISTON	
	1	10-200-102	PISTON	
	1	01-050-182	O-RING, PISTON, LARGE, AMBER	
○	1	10-200-105	ENVIRONMENTAL S.P.E.C. BOOT	
	1	10-200-103	CAP	
	2	10-101-104	LP PLUG (3/8-24)	
	2	01-050-132	O-RING, LP PLUG, BLUE	
	2	10-101-006	PLUG, LP (3/8-24) WITH O-RING	
	1	01-050-138	O-RING, HP PLUG, BLUE	
	1	01-101-139	HP PLUG (7/16-20)	
	1	10-101-039	HP PLUG (7/16-20) WITH O-RING	
	1	01-050-157	O-RING, YOKE RETAINER. RED	
	1	10-103-112	YOKE RETAINER	
	1	01-073-101	RETAINER, FILTER	
○	●	10-200-020	SPEC KIT, W/BOOT & SILICONE GREASE	

Technical Information:

This first stage may be similar in appearance to the MK2 and MK3 first stages, and shares some common components. Be sure to properly identify the first stage prior to service and use the appropriate schematic to avoid mixing incompatible parts.

Special Engineering Notes:

Maximum 3 washers #01-060-101 are used to adjust intermediate pressure to specified limits.

Legend (prices subject to change without notice)

- Not Shown ◇ Dynamic O'Ring Replace Annually
- Optional Item ◇ Annual Replacement
- ▲ Limited Warranty [] Torque In Inch Pounds
- Older Configuration * See Note